

OCEANIS 30.1

E-BOOK



BENETEAU
AVANT-GARDE IN BOATING

1. Key Points

Oceanis 30.1

E -BOOK



The Smart Multi-programme



The Smart Multi-programme

The third of the new generation of Oceanis sailing yachts renews the entry level and has many key features that set her apart:

SMART
EASY
COMFORT
VOLUME



Specifications

GENERAL SPECIFICATIONS

• L.O.A	9,53 m 31'3"
• Hull length	8,99 m 29'6"
• L.W.L.	8,65 m 28'5"
• Beam (max)	2,99 m 9'10"
• Deep draft (Cast iron)	1,88 m 6'2"
• Deep ballast weight	973 kg 2,144 lbs
• Shallow draft (Cast iron)	1,30 m 4'3"
• Shallow ballast weight	1 150 kg 2,535 lbs
• Lifting keel version (Ballast melting)	0,95 - 2,33 m 3'1" - 7'8"
• Lifting keel version ballast weight	1 300 kg 2,865 lbs
• Air draft	13,66 m 44'10"
• Light displacement	3 995 kg 8,805 lbs
• Fuel capacity (standard)	130 L 34 US Gal
• Fresh water capacity (standard)	160 L 42 US Gal
• Engine power (standard)	15 HP 15 HP
• Engine power (Option)	21 HP 21 HP

SAILS DIMENSIONS

• Square top mainsail	23,80 m ² 256 sq/ft
• Furling mainsail	18,80 m ² 202 sq/ft
• Self-tacking jib	15,70 m ² 169 sq/ft
• Genoa (105 %)	22,10 m ² 238 sq/ft
• Code 0	34,80 m ² 374 sq/ft
• Asymmetrical spinnaker	70,00 m ² 753 sq/ft
• I	11,02 m 36'2"
• J	3,87 m 12'8"
• P	10,81 m 35'6"
• E	3,27 m 10'9"

ARCHITECTS / DESIGNERS

• Naval Architect	Pascal Cong
• Interior design	Nauta Design

EC CERTIFICATION

• Category B	6 people
• Category C	8 people
• Category D	10 people

The Smart Multi-programme

SMART

She is suited to everyone's programmes and all sailing grounds, with:

A tiller for sailors who love thrills and excitement or who come from dinghy sailing

Twin steering wheels for a cruiser spirit and the feel of a small yacht. This version has a completely clear cockpit, making it a wonderfully social space

4 ballasts so you can sail, whatever kind of configuration you have in your favourite sailing area: large fixed keel or shallow draught, ballasted dinghy, swing keel

Rotating mast to adapt to the constraints of inland waterways (mast development in progress)



The Smart Multi-programme



EASY

Designed to be easy to sail: a standard layout ideal for family cruises or short-handed sailing

Only 1 winch as standard
Self-tacking jib
No backstay

Choice for optional furling mast

The Smart Multi-programme



COMFORT

Sailing comfort

- The hull makes for extremely comfortable sailing since the chined construction reduces heeling.
- The absence of a backstay frees up space to stern
- The boat is easy to move about with a big cockpit, even close to the companionway, that can hold 6 people without getting in each other's way.



Living comfort on board:

- The hull provides incredible living space indoors, with generous volumes everywhere.
- The soles have been lowered on the flats, resulting in greater headroom (1.98 m in the saloon / 1.85 in the cabins)

The Smart Multi-programme

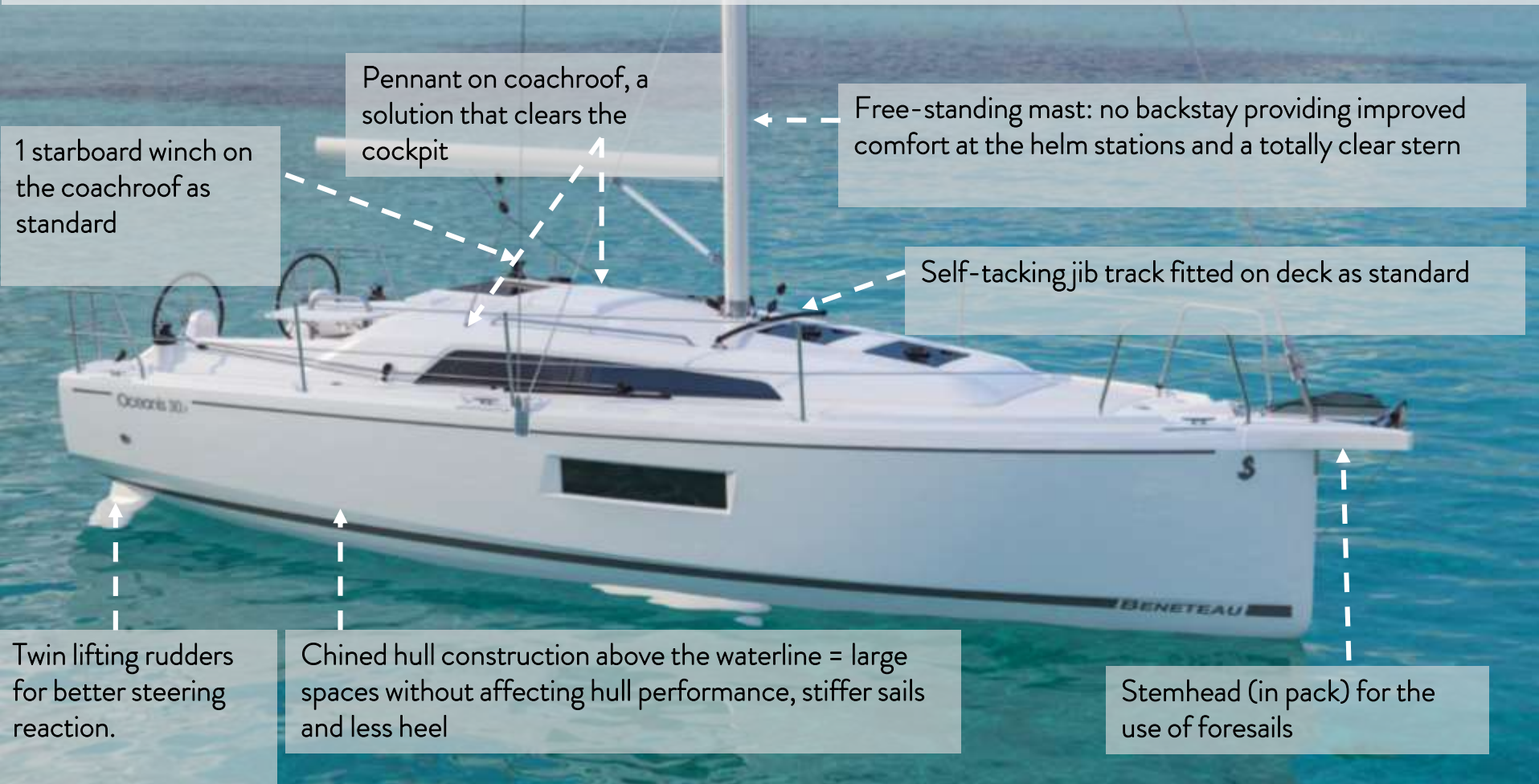

1 starboard winch on the coachroof as standard

Pennant on coachroof, a solution that clears the cockpit

Free-standing mast: no backstay providing improved comfort at the helm stations and a totally clear stern

Self-tacking jib track fitted on deck as standard

Twin lifting rudders for better steering reaction.

Chined hull construction above the waterline = large spaces without affecting hull performance, stiffer sails and less heel

Stemhead (in pack) for the use of foresails

The Smart Multi-programme

Unstayed mast and swept back spreaders. Gets rid of the backstay and frees up aft movement.

Square-top mainsail as standard: larger sail area at the top = increased performance in all points of sailing. Is not suited to the optional furling mast.

Port manoeuvring winch H20.1 STA (in Downwind pack). Standard starboard winch

Genoa sheet winches H35.2STA (in Upwind or Downwind pack)

Choice of 4 ballasts: with which the boat can be adapted to all sailing grounds and everyone's programme

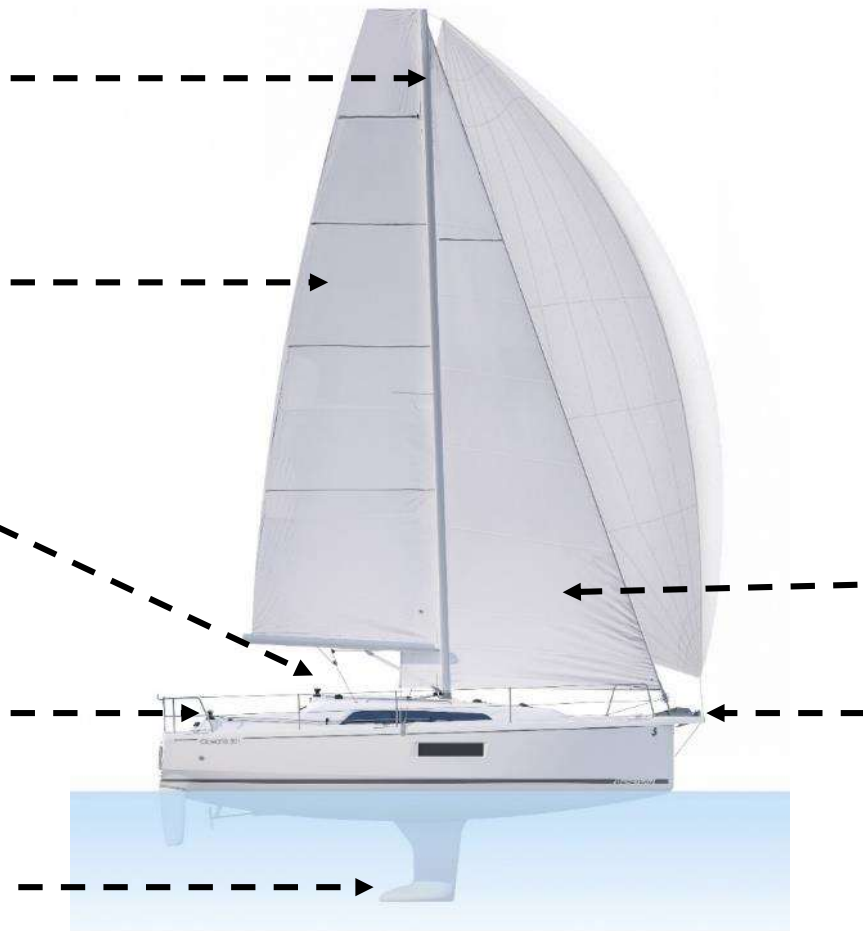

SMART

Easily customizable thanks to the wide choice of rigging, deck hardware and ballast. It suits everybody: beginners or sailors in search of excitement will find this boat ideal

Genoa available in the Upwind Pack. 105% overlap. As a replacement for the standard self-tacking jib

Stemhead with integrated anchor (in Downwind Pack) for the use of foresails.

The Smart Multi-programme



The swing keel : an appendage with a number of advantages.
Deep draught performance with the appeal of dinghies

- **Performance under sail:** the performance of very deep ballast in all points of sailing with limited drag (no bulb)
- **Incredible stability** without increasing the light displacement (weight identical to a deep draught fixed keel)
- **Beachable boat:** ideal for areas with a high tidal range, hull strengthened for the use of legs
- **Inaccessible sites become explorable:** in the lifted position the shallow draught gives access to shores and sailing areas with shallow waters
- **Extremely easy to work:** just press on the control button in the cockpit to raise and lower

The Smart Multi-programme



The swing keel: an appendage with a number of advantages.
Deep draught performance with the appeal of dinghies

- A very safe system:

In the event of collision the cylinder pressure is released so as not to damage the keel.

A completely watertight structure: the casing is moulded along with the hull. In addition, in the raised position, the centreboard always remains outside the hull.

Several openings have been anticipated to facilitate maintenance

The centreboard can only be worked when the engine is underway: no risk of a badly positioned centreboard under sail

Interior

Layout version:

2 cabins with large berths and stowage, 1 full-beam saloon with 2 good-sized bench seats and an optional chart table, 1 fitted L-shaped galley, 1 big shower room, 1 generous space for the sail locker that can be reached from the port cockpit bench.

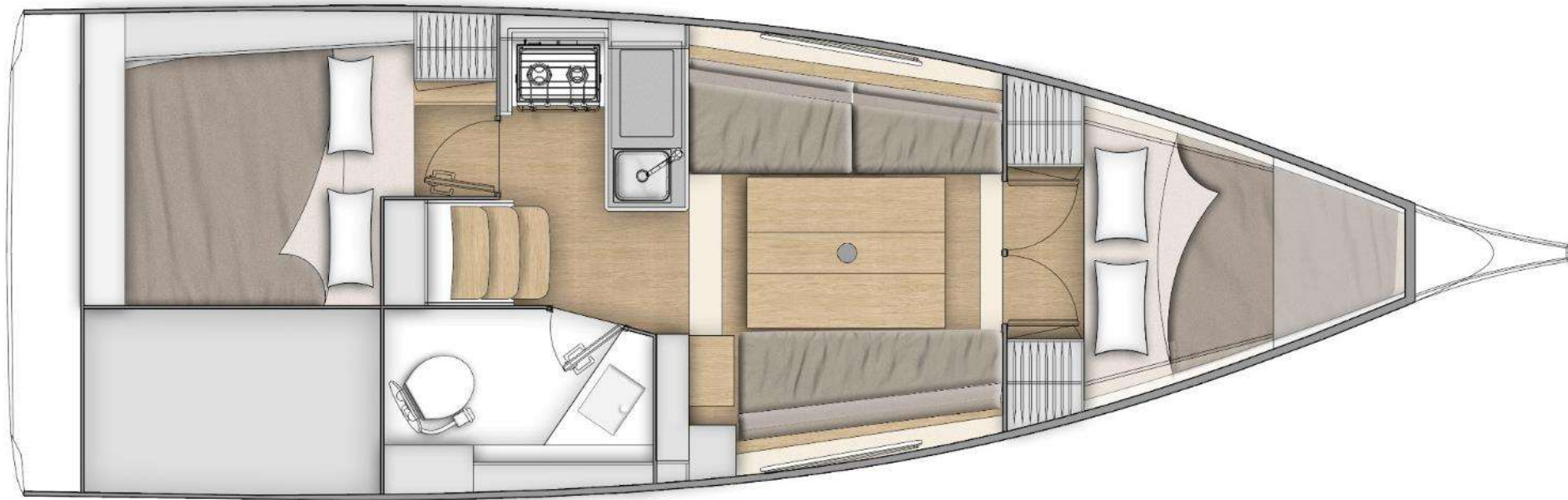

Saloon



Optional chart table: Library with 2 shelves with fiddles, above the fold-away top

Gently sloping 33° companionway

Entrance to portside aft cabin

L-shaped galley, practical when heeling.

Interior bathed in light and well ventilated: deck hatch, large hull portholes, coaming glazing, etc. All the curtains and blinds are included in the trim

Electrical panel / VHF location

Full-beam saloon, long comfortable bench seats (1.90 m). Can be used as extra single bed

Large saloon table with 2 large fold-down flaps

Saloon

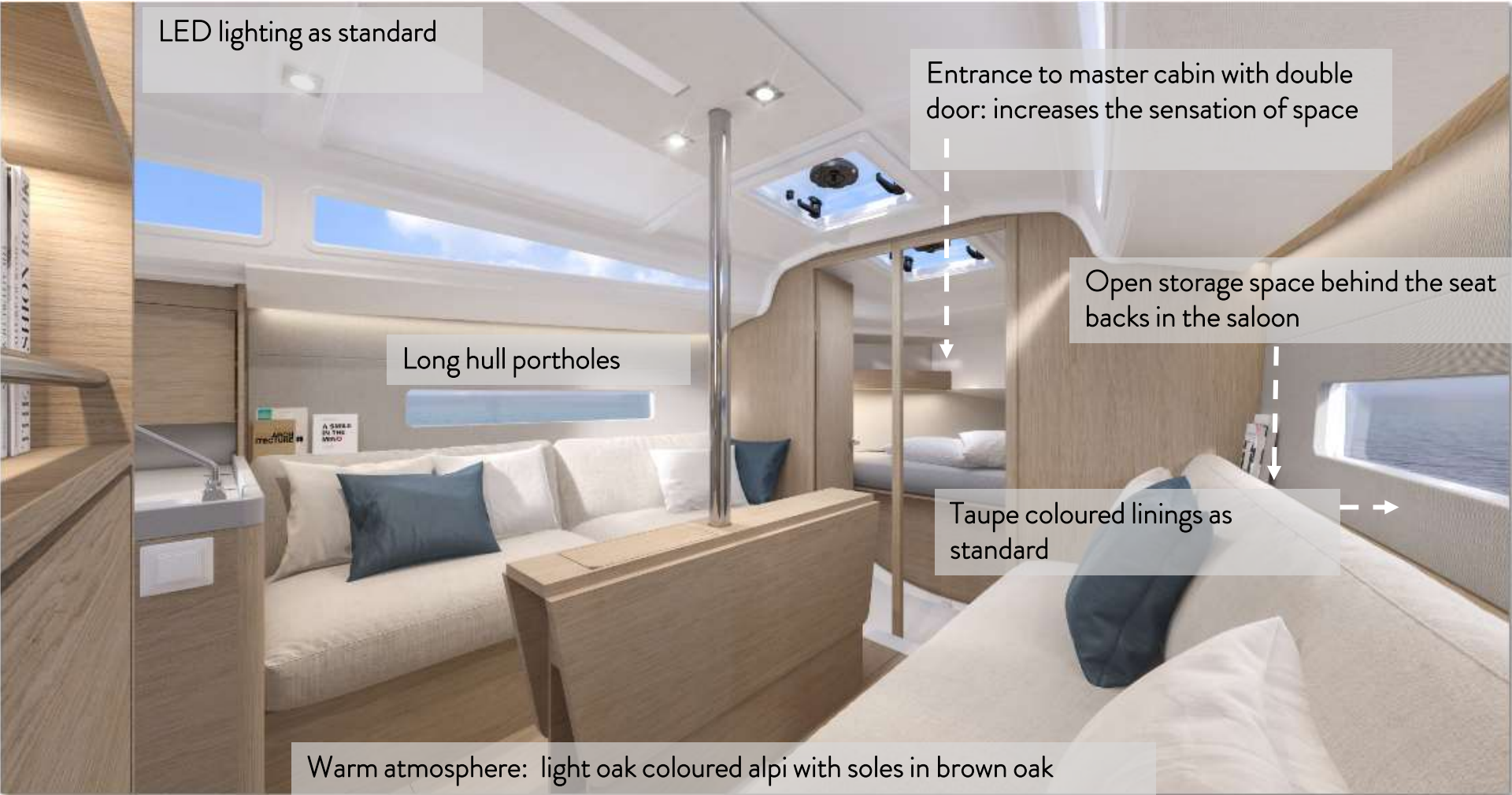

LED lighting as standard

Entrance to master cabin with double door: increases the sensation of space

Long hull portholes

Open storage space behind the seat backs in the saloon

Taupe coloured linings as standard

Warm atmosphere: light oak coloured alpi with soles in brown oak

Galley

Deck hatch with vent: the boat is always well-ventilated

Opening porthole over the galley

1 open shelf area with fiddles on the 2 shelves.
1 closing top unit.

75 L / 20 US Gal Icebox with 2 openings on top (refrigerator unit as trim)

1 sink, 35 x 32 cm

Compact Clay worktop

Drawer for cutlery under the sink

Integrated stowage + gas cylinder locker

2-ring hob and oven as standard (grill on option)



Fore cabin

Height to deck beam: 1.85 m. / 6'1"

1 deck hatch with vent and blind
/ mosquito screen as trim

Double door

Indirect LED lighting beneath
the shelves along the hull

LED reading
lights

Taupe coloured lining as
standard

2 closed storage areas on either side of the
bed: starboard hanging locker and shelves.

Good sized berth:
2.00 m x 1.90 m - 0.50 m / 6'7" x 6'3" - 1'8"



Aft cabin

Height to deck beam: 1.89 m. / 6'2"

2 opening portholes as standard:
very good ventilation

Open shelving

Indirect LED lighting beneath the
shelves along the hull

LED reading
light

Cupboard
with shelves

Taupe coloured lining as
standard

Big double bed
(2.00 m - 1.85 m x 1.60 m - 1.35 / 6'7" - 6'1" x 5'3" - 4'5")



Shower room

Height to deck beam: 1.88 m. / 6'2"

Spacious, bright and well-ventilated
Lots of storage space
Inbuilt washbasin with mixer tap
Shower
Manual head

AMBIANCE

Standard

White oak alpi/
Alpi Chêne flotté



Laminated brown oak floor /
Parquet stratifié chêne brun



Interior upholstery /
Sellerie intérieure
Néo 05



Padding upholstery /
Capitonnages
Taupe



Options

Interior upholstery /
Sellerie intérieure
PVC Marlin Weiss



Exterior protections /
Protections extérieures
Cadet Grey



Exterior upholstery /
Sellerie extérieure
Dolce 51

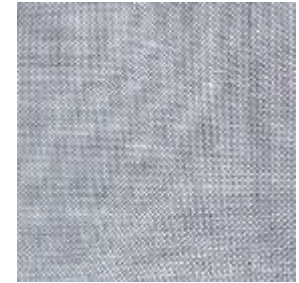

Hull /
Coque
Pearl Grey / Gris perle



2. Exterior dimensions

Cockpit benches with tiller / Bancs de cockpit avec barre franche : 1,70 m / 5'7"

Cockpit benches with steering wheels / Bancs de cockpit avec barres à roue : 1,50 m / 4'11"

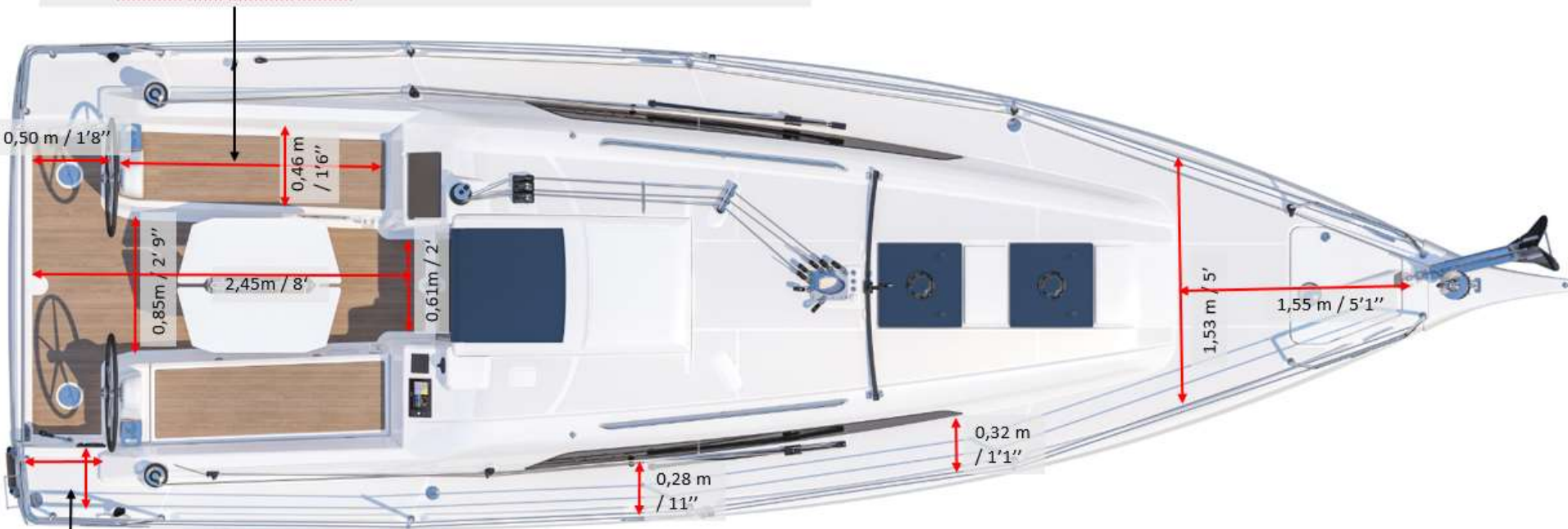

0,43 m x 0,38
/ 1'5" x 1,3"

Aft platform option / plateforme arrière
1,90 m x 0,35 / 6'3" x 1'2"

Cockpit table / Table de cockpit
1,00 m x 0,81 / 3'3" x 2'8"

3. Interior dimensions

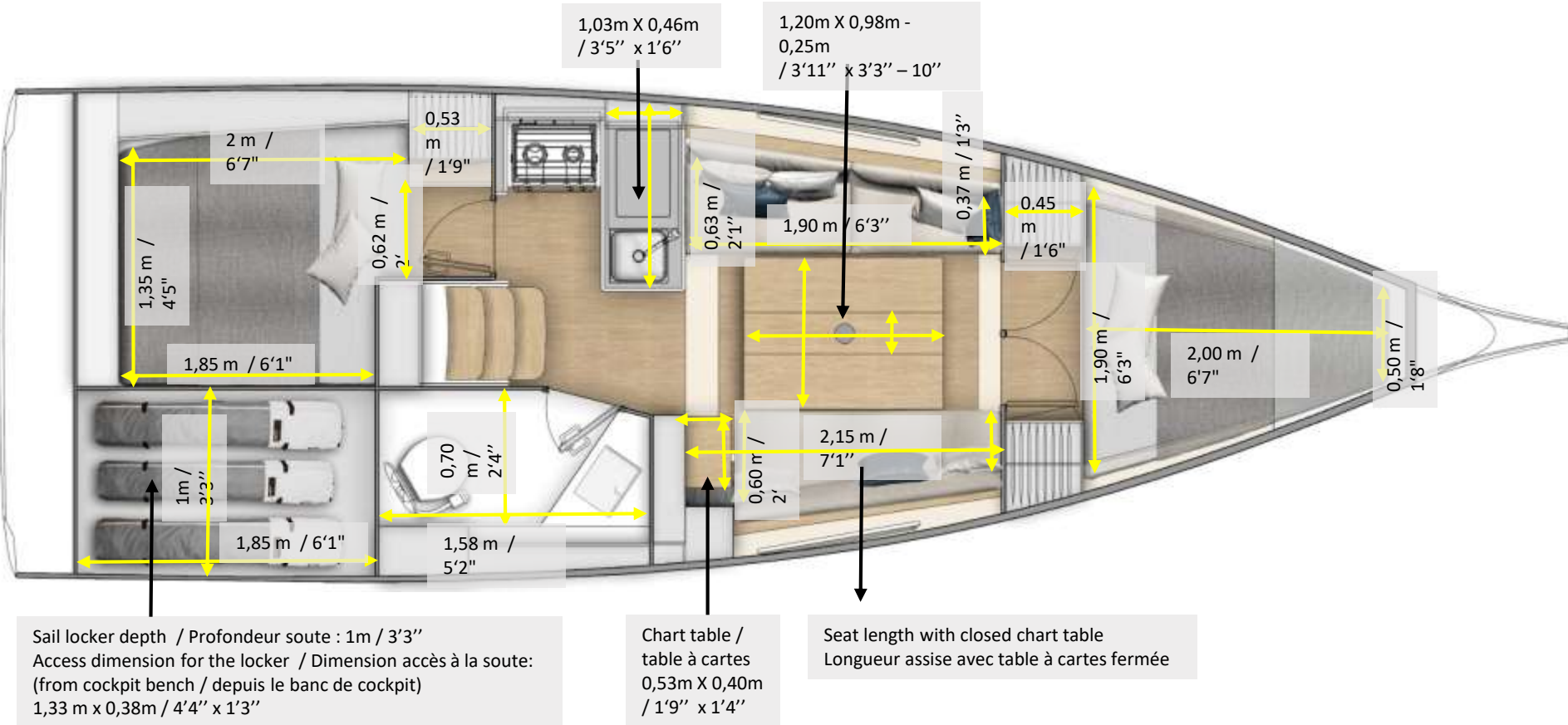

4. Location for technical equipments



- 1** Fuel tank 130L / 34 US Gal - standard
- 2** Fresh water tank 160 L / 42 US Gal - standard
- 3** Rigid blackwater tank - 80 L / 21 US Gal - standard
- 4** Water heater 25 L / 7 US Gal - standard
- 5** Plumbing board (expansion tank - water collection generator, etc.)
- A** Electrical panel
- B** Inverter 700 VA 12 V - 230 V - *option*
- C** B 1 house battery 80 amp - 1 engine battery 50 am - standard
- D** Battery charger 40 amp, 1 service battery 80 amp - *option*
- E** Water heater - *option*